

If in doubt – Ask

Dimensions in Millimeters Unless Otherwise Stated

Do Not Scale This Drawing

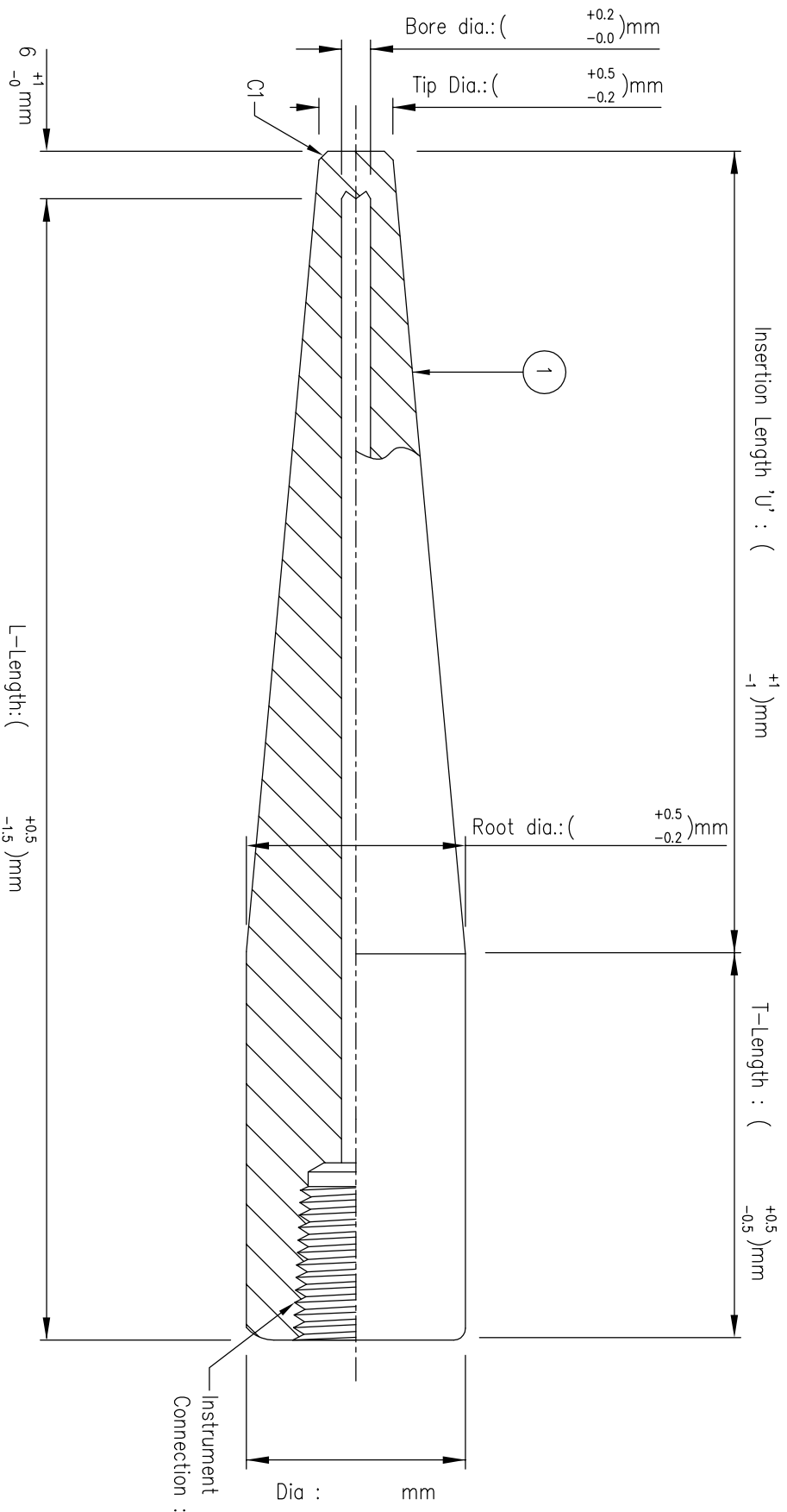

Model No [TW512W]

| Heavy Duty Welded Thermowell – Lurgi Style | | | |
|--|--|--|--|
| Tolerance | | Length < 1 mtr (± 1 mm), 1 mtr < Length (± 2 mm) < 2 mtr | |
| CUSTOMER | | | |
| Wai Lin | | Toe Toe Lwin | |
| DRAWN BY | | APPROVED BY | |
| STD DWG NO. | | TW512W-4 | |
| QUOTATION NO. | | | |
| SINGAPORE 609133 | | ACEZ SENSING PTE LTD | |
| 28E PENJURU CLOSE, #01-04 | | SINGAPORE 609133 | |
| TEL: 65-6265 1588 FAX: 65-6264 3992 | | Website: www.acezsensing.com | |

| S/N | DESCRIPTION | MATERIAL | QTY. | REMARK |
|-----|---------------------------------|----------|------|--------|
| 1 | Drilled Bar Stock – Taper Style | | 1 | |