

DIVIDER OF THREAD THERMOWELLS
(TAPER THREAD)

STEM TYPE

TAPERED

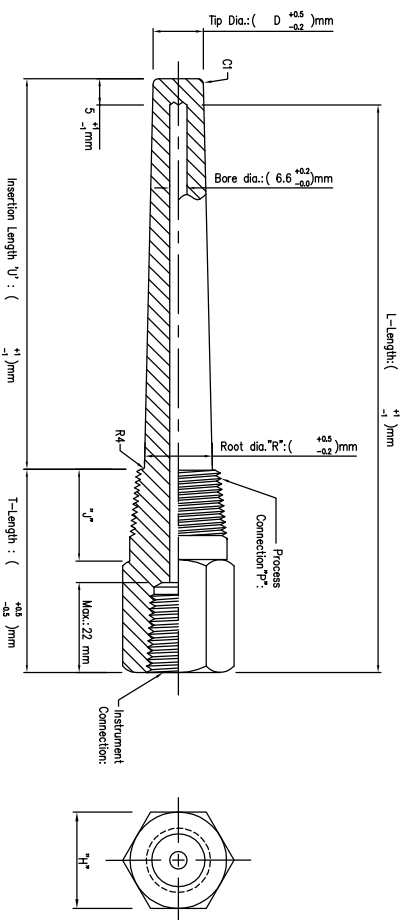

HEX Size (H)	Thread (Process Connection) (P)	Thread (J)	Root Diameter (R)	Tip Diameter (Tapered Stem) (D)
28.5 mm	1/2" NPT	19 mm	17 mm	13 mm
28.5 mm	3/4" NPT	19 mm	19 mm	13 mm
35 mm	1" NPT	25 mm	26.5 mm	18 mm
28.5 mm	1/2" BSPT	19 mm	17 mm	13 mm
31.75 mm	3/4" BSPT	19 mm	19 mm	13 mm
35 mm	1" BSPT	25 mm	26.5 mm	18 mm

Tapered Type

STRAIGHT

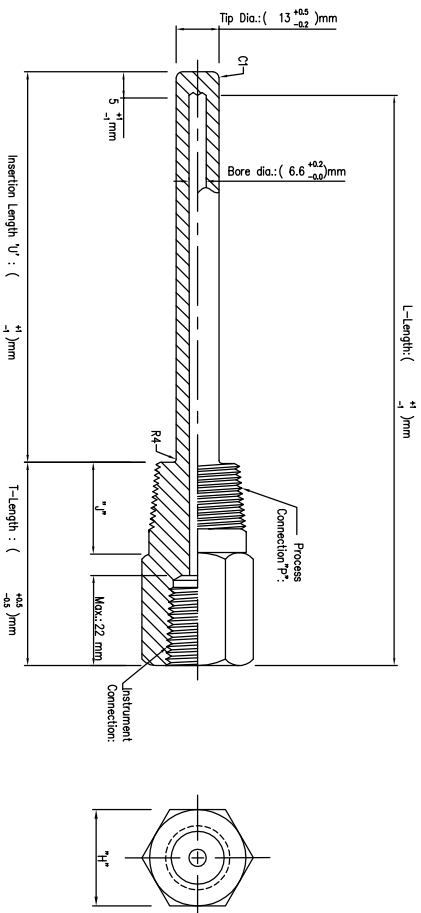

STEPPED

